

CD

Window fans



Window Kit Specification Components - For Full Kit

Size	Fan	Price ex. VAT (£)	Window Kit	Price ex. VAT (£)
6" Window Kit	CD6	£350.62	EW6	£230.51
9" Window Kit	CD9	£382.53	EW9	£262.15
12" Window Kit	CD12	£414.95	EW12	£297.75

Features and benefits

- Self-adhesive external plate allows easy one person fix on-site
- Thermo-actuated backdraught shutters ensure silent operation and positive closure when fan is off
- Reversible supply or extract, variable speed operation
- Choice of controllers, remote and integral sensors
- Suitable for glazing thicknesses of up to 32mm and wall/panels of 360mm
- Low noise levels
- 6", 9" and 12" models available



Front

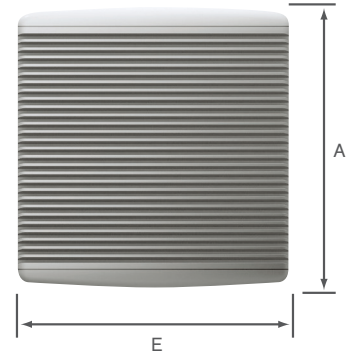

Side

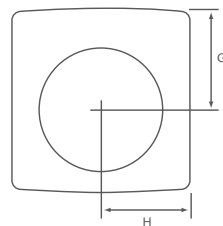
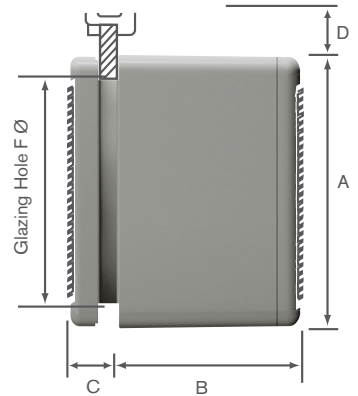

	6"	9"	12"
A	272	342	420
B	160	158	167
C	37	37	41
D min	50	50	50
E	269	342	420
F Ø	184	260	337
G	138	175	215
H	135	171	207

Models, control options and key data

*Sound pressure level measured @ 3 metres **See components table above Note: figures are extract only

Product code		Performance to BS 848 Pt1 in free air (m ³ /h)		Sound pressure level dB(A)*		Consumption (W)	
		Boost	Eco	Boost	Eco	Boost	Eco
CD6	6" commercial fan - installed within a window kit specification**	419	227	45	28	38	20
CD9	9" commercial fan - installed within a window kit specification**	830	724	50	43	50	37
CD12	12" commercial fan - installed within a window kit specification**	1690	1228	51	44	100	70

FOR SINGLE PRICE FAN PLEASE REFER TO PAGE 30

Physical specification for complete CD window fan kit

All measurements in millimetres unless otherwise indicated

Weight: 3.6kg
5.2kg
7.4kg

Materials: ABS plastic

Ancillaries for CD

For details of remote or integral sensor options/ switches see page 39. For full kit accessories EW6, EW9, EW12 see page 40

Installation

Wiring: Must comply with IEE Regulations

Cable: Ø 1mm² max or min

Fuse: 3 amp (when fan is supplied from a 6A lighting circuit no local fuse is required)

Electrical specification: 230V-50Hz Class I

Consumption: Boost = 38W, Eco = 20W
Boost = 50W, Eco = 37W
Boost = 100W, Eco = 70W

Performance

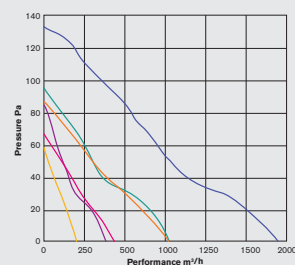

- CD6 Extract
- CD6 Supply
- CD9 Extract
- CD9 Supply
- CD12 Extract
- CD12 Supply